

PLAN SHOWING THE PLOT HAVING AREA 5760 SQ FT OR 8 KATHA OR 0.1322 ACRES MORE OR LESS INSIDE RS PART PLOT NO- 1075, LR PLOT NO- 3051, LR KHATIAN NO- 1420 OF MOUZA- DEMURARI GOPINATHPUR, JL NO-205 UNDER WARD NO-4 OF BANKURA MUNICIPALITY, PS & DIST- BANKURA SHOWN WITH RED BORDER THUS- 

NAME OF OWNER- 1. KUNTAL BHATTACHARJEE
 VILL + PO- BAMUNARE, DURGAPUR, PS- KANKSHA, DIST- PASCHIM BURDWAN, PIN- 713212

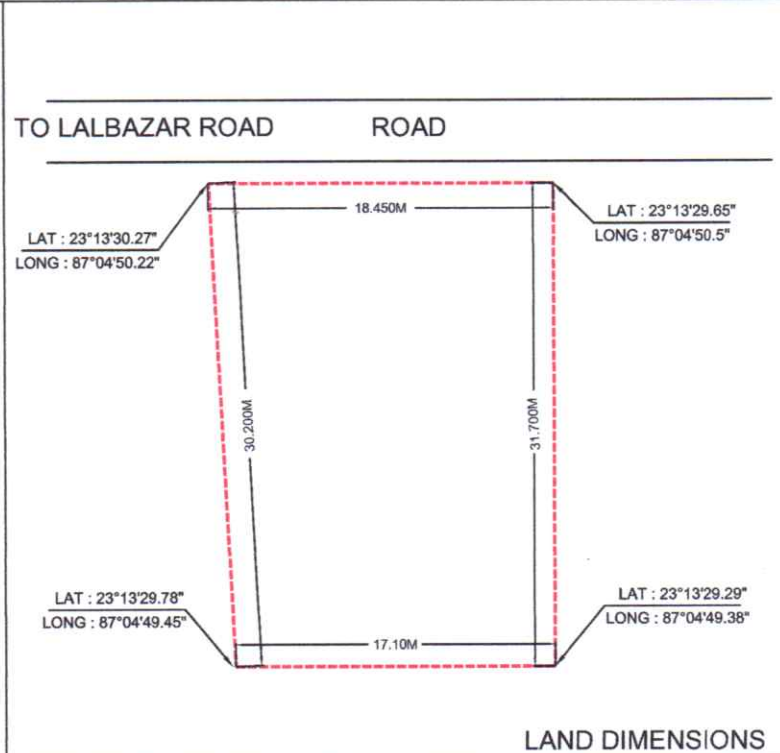
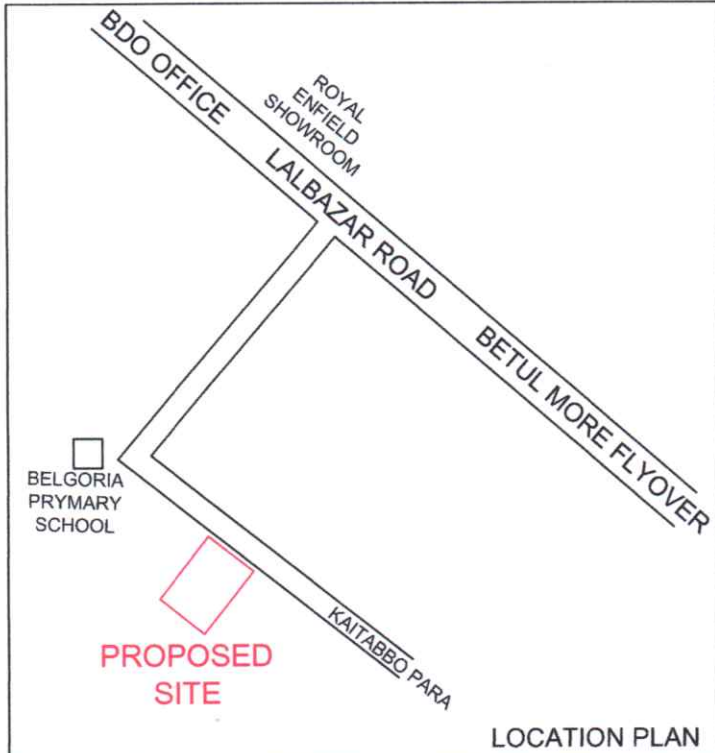

2. DIPANKAR DUTTA
 C/1 IMAN KALYAN SARANI, BIDHAN NAGAR, PS- BIDHANNAGAR, DURGAPUR, DIST- PASCHIM BURDWAN, PIN- 713212

REPRESENTING KESHOB REAL ESTATE PVT. LTD.
 PLOT A/0455B, SECTOR- 2A, BIDHANNAGAR, DURGAPUR- 713212, PS- NEW TOWNSHIP, DIST- PASCHIM BURDWAN, W.B.

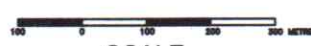

DEMURARI GOPINATHPUR
 MOUZA NAME : DEMURARI GOPINATHPUR
 J.L. NO. : 205/ SHEET NO-9
 POLICE STATION : BANKURA
 DISTRICT : BANKURA

SCALE 1" = 1 MILE
 OR
 SCALE 1 METRE = 3.96 KILOMETRE

<p>PREPARED BY-</p> <p>GLOBAL SURVEYORS REGD OFFICE- SEARSOLE BABUPARA P.O.- SEARSOLE RAJBARI, DIST :-PASCHIM BURDWAN (W.B) PH- 94342 37231, 9933738261 EMAIL- info@globalsurveyors.org globalsurveyors2001@yahoo.co.in WEBSITE- www.globalsurveyors.org (AN ISO 9001:2015 CERTIFIED FIRM)</p>	<p>DIRECTION</p> 	<p>DRAWING NO- DATE</p> <p>GS/MIPL/2023/ MPLAN/1 OF 4</p>  <p>SCALE</p>	<p>SIGNED & VERIFIED BY-</p>  <p>GLOBAL SURVEYORS ANJALI SEARSOLE BABU PARA SOLE RAJBARI, PS. RAJGALLI, PIN- 713200 DIST. PASCHIM BARDHAMAN (W.B)</p>
--	--	---	---